

MMDA [A]/PP No. *19354/90*  
 C.No. *A2/19354/90*  
 A.P. *26/9*  
 D.P. *21/10/11*

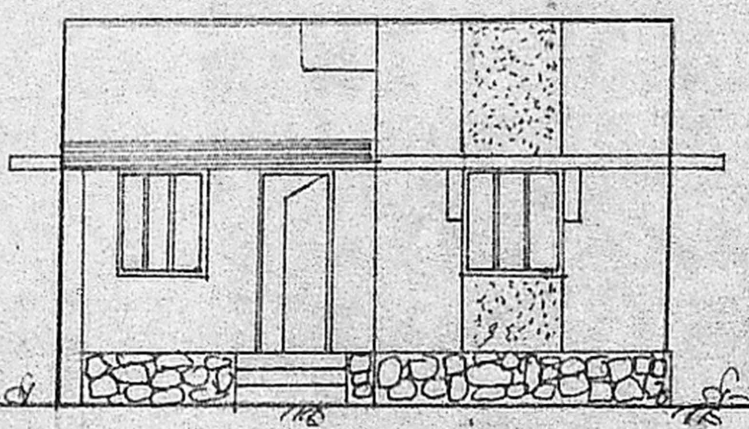

ELEVATION

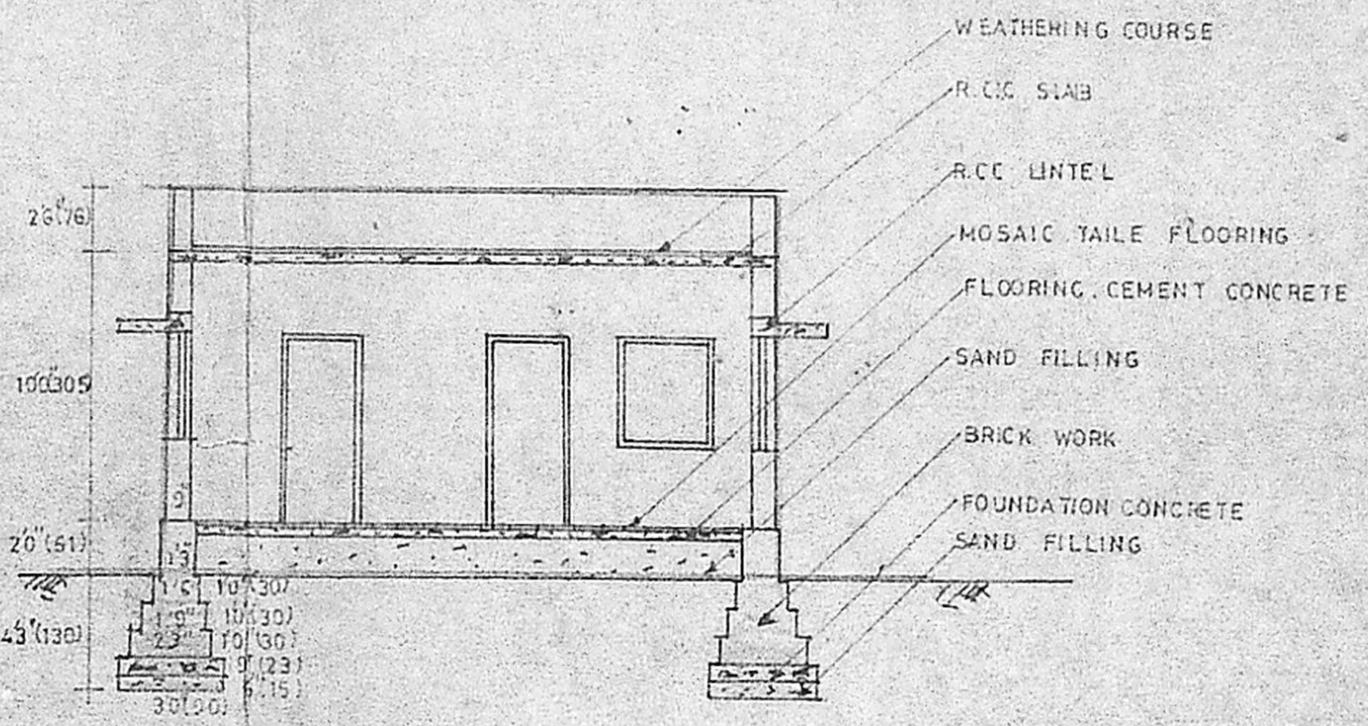

C. SECTION AT 'AB'

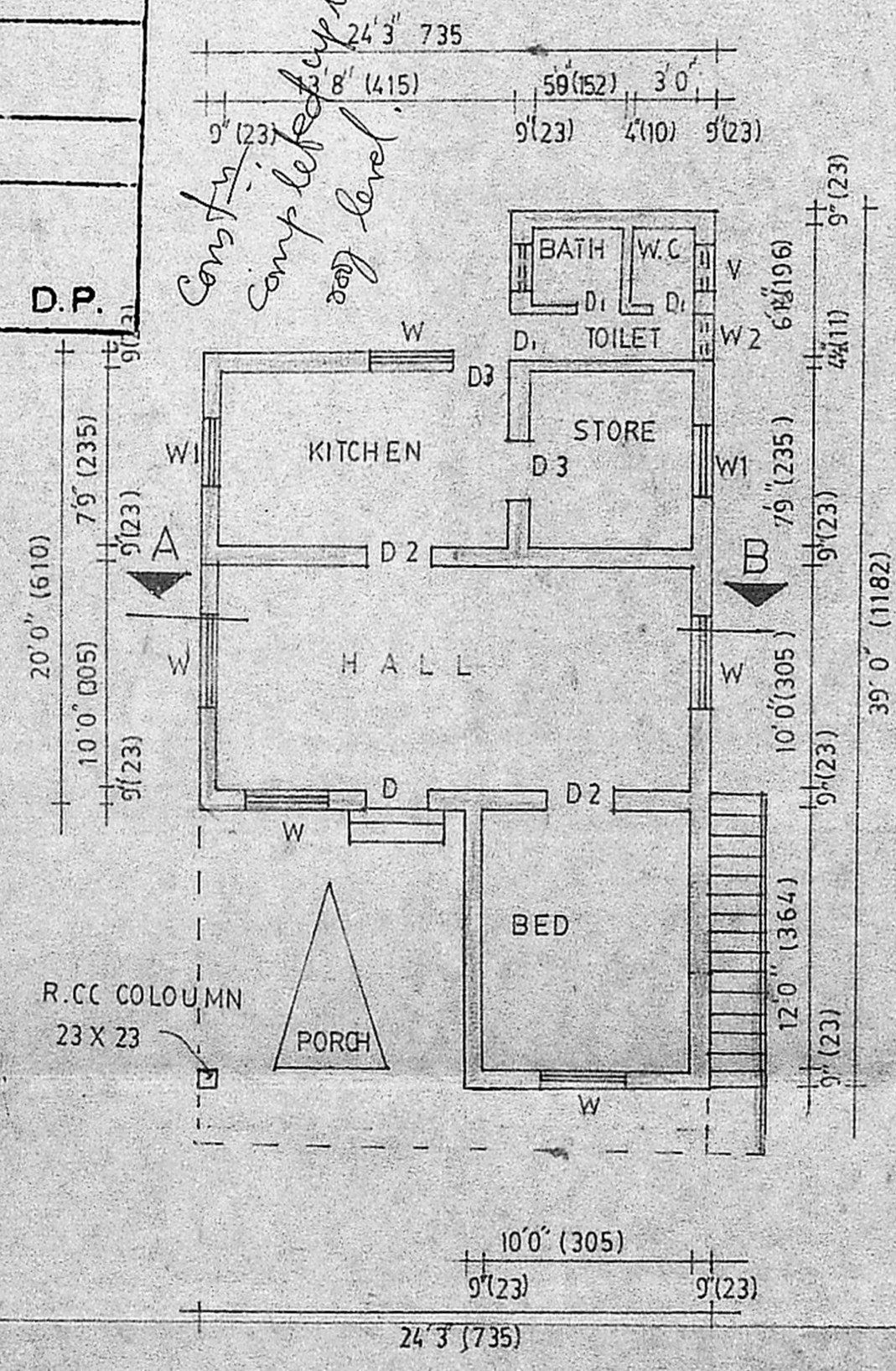

PLAN

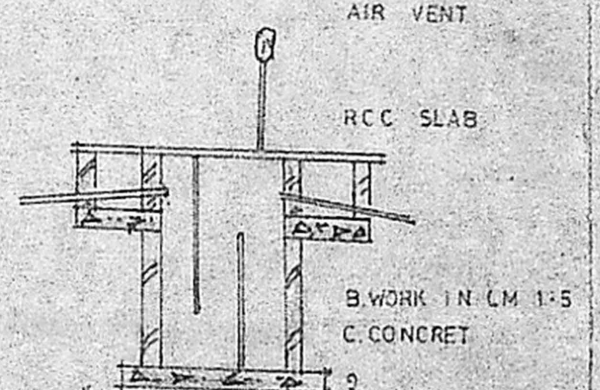

Planning Permit No. *A/312/91*  
**APPROVED**  
 SUBJECT TO THE CONDITIONS IN THIS OFFICE LETTER.  
 No. *A2/19354/90* Date *28-3-91*  
 FOR MEMBER SECRETARY  
 MADRAS METROPOLITAN  
 DEVELOPMENT AUTHORITY  
 MADRAS - 600 008

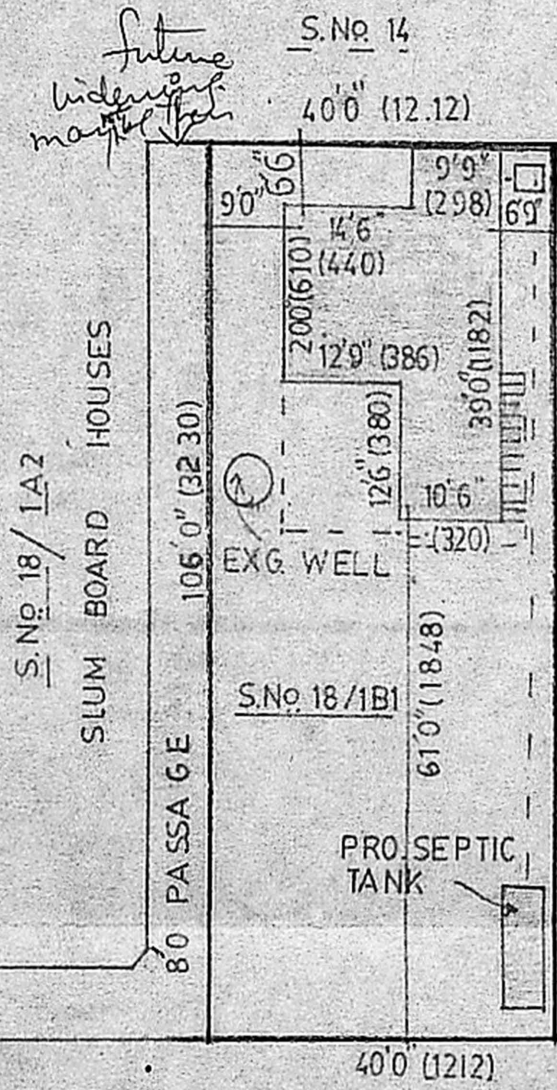

SITE PLAN SCALE 1:300

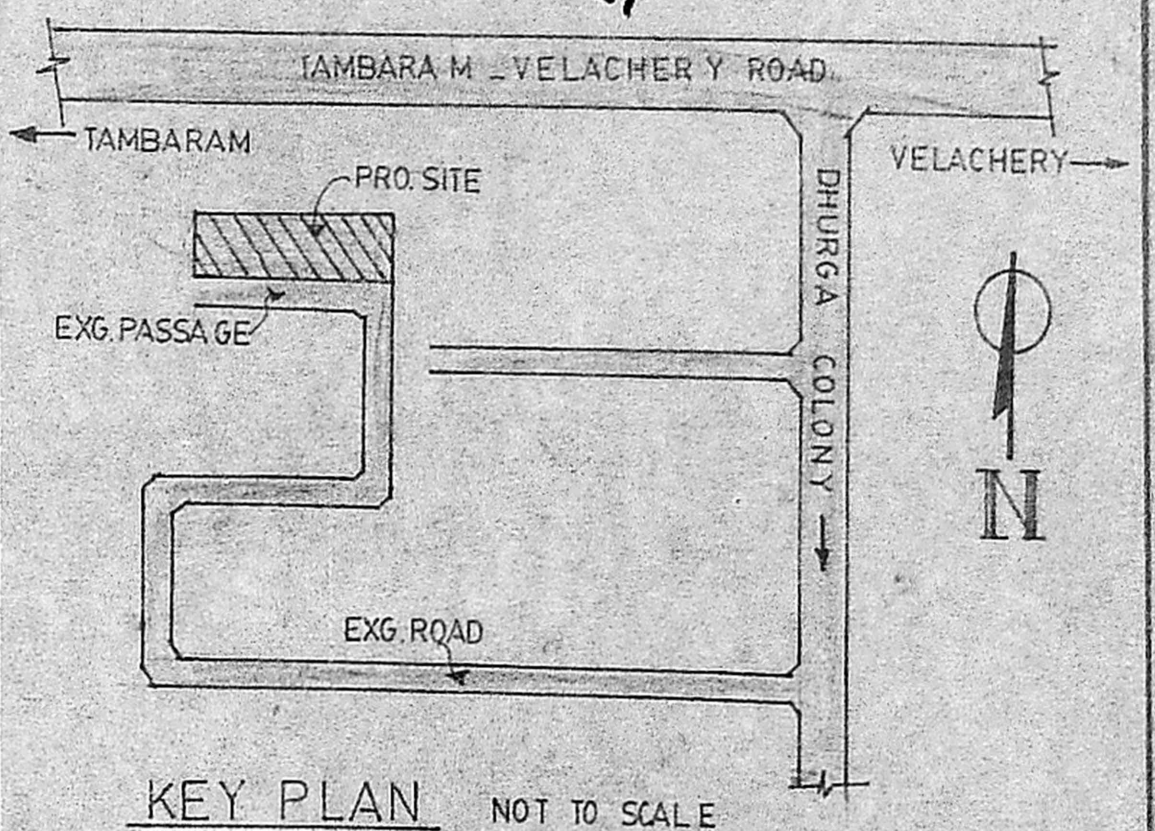

KEY PLAN NOT TO SCALE

JOINERIES DETAILS			AREA DETAILS	
D1 DOOR	33X70	100X213	SITE AREA	= 41200 SF 378.30
D2 DOOR	20X60	60X183	PRO. P. AREA	= 6930 " 6363 SM
D3 DOOR	30X66	90X108	SITE COVERAGE	= 16.8%
W1 WINDOW	40X40	122X123	F.S.I	= 0.168
W2 WINDOW	30X40	90X122		
V1 VENTILATOR	26X16	76X45		

PLAN SHOWING THE PRO. RESIDENTIAL BUILDING IN S.No 18/1B1, OF 174 RAJA KIL PAKKAM VILLAGE, SAIDAPET TALUK, CHENGAI-ANNA DISTRICT.

Scale = 1:100 & 300

*K. Krishnarajan*  
 K. Krishnarajan, L.C.E.  
 Consulting Engineer  
 Licensed Surveyor  
 MADRAS CORPORATION &  
 TAMBARAM MUNICIPALITY  
 LICENSE No. 486 (IInd Class)  
 1, Brincavan Avenue, Kennedy Street  
 WEST TAMBARAM, MADRAS-600 048  
 L.S.

K. Akila

OWNER